

COMMUNITY SCHOOLS

Toronto District School Board	416.397.3000
www.tdsb.on.ca	
JK-5 Norman Ingram P.S.	416-395-2720
50 Duncairn Rd	
JK-5 Greenland P.S.	416-395-2500
15 Greenland Rd	
6-8 Don Mills Middle School	416-395-2320
17 The Donway East	
9-12 Don Mills CI	416-395-3190
15 The Donway East	

French Immersion Programs

www.tdsb.on.ca	
SK-6 Broadlands PS	416-395-2090
106 Broadlands Blvd	
7-9 Windfields Junior High School	416-395-3100
375 Banbury Road	
10-12 York Mills CI	416-395-3340
490 York Mills Rd	

Toronto Catholic District School Board

www.tcdsb.on.ca	416.222.8282
JK-8 St. Bonaventure Catholic School	416-393-5263
1340 Leslie Street	
9-12 Senator O'Connor	416-393-5505
60 Rowena Dr	

Toronto Private Schools

www.edu.gov.on.ca/eng/general/elemsec/privscho	
PK-8 The Giles School (Co-ed)	416.446.0825
80 Scarsdale Road	
PK-12 Hawthorn School (Girls)	416.444.2900
101 Scarsdale Road	
JK-6 Crestwood School (Co-ed)	416.444.5858
411 Lawrence Avenue East	
7-12 Crestwood Preparatory College (Co-ed)	416.391.1441
217 Brookbanks Drive	
1-12 WillowWood School (Co-ed)	416.444.7644
55 Scarsdale Road	
3-12 Crescent School (Boys)	416.449.2556
2365 Bayview Avenue	
3-12 Bayview Glen (Co-ed)	416.443.1030



Team@TheMillsTeam.ca | 416.443.0300



Lauren Rebecca*, Sarah O'Neill*, Katie Mills*, Sue Mills*, Alex Mills**,
Victoria Mills Delsnyder, Diane Fujita*, Laura Lee* | * SALES REPRESENTATIVE ** BROKER

THE MILLS TEAM

is proud to present

9 NORDEN
CRESCENT



9Norden.com

TheMillsTeam.ca

9Norden.com

TheMillsTeam.ca



ADDITIONAL INFO

- Taxes:** \$5,159.80 (Annual in 2016)
- Lot Size:** 49.94 feet x 157 feet irregular as per survey (East: 152', West: 162', Rear: 54' + 21'=75')
- Parking:** Single carport plus private driveway with parking for 3 cars
- Possession:** 30-60 Days/TBD
- Heating:** Forced air gas furnace with central air conditioning
- Utility Costs:** Electrical: Approx. \$88/month (2016)
Gas: Approx. \$79/month (2016)
- Inclusions:** GE stainless steel refrigerator/freezer, stove, washer and dryer, all in "as is" condition. All electric light fixtures, all attached shelving and cabinetry, all parts of furnace and central air conditioner, City of Toronto garbage and recycling containers
- Rental:** Hot water tank (if a rental)



A Home Inspection Report dated June 2nd, 2017 is available for your convenience and information purposes only. Any reliance on this Report and its contents is at the Buyer's own discretion.



9 NORDEN CRESCENT

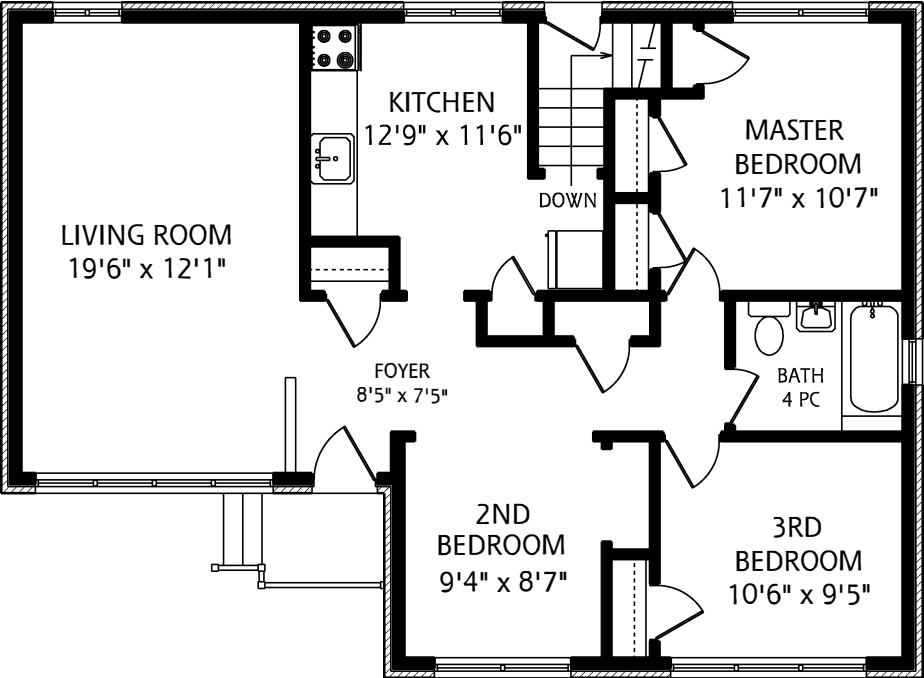

MAIN FLOOR
1,040 SQUARE FEET

ALL MEASUREMENTS SHOULD BE CONSIDERED APPROXIMATE

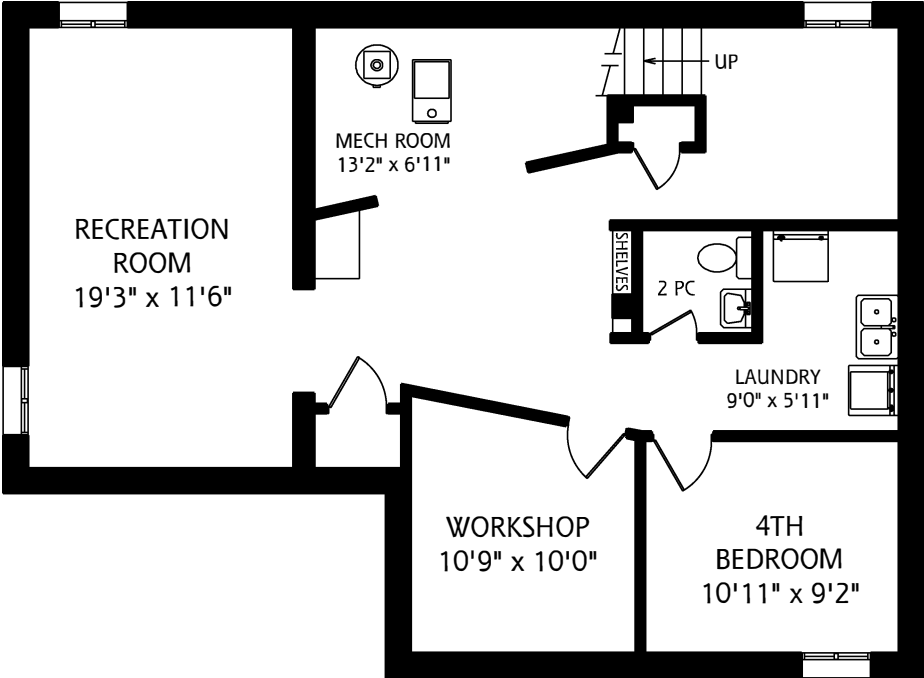

LOWER LEVEL
1,040 SQUARE FEET